



Oswald Road, Fetcham, KT22 9TZ

V&H
HOMES

Your local property specialist

Oswald Road Fetcham KT22 9TZ

Situated on a popular road conveniently located for Fetcham village, this three bedroom end of terrace property is in need of modernisation, with potential to extend (STPP).

Three Bedrooms

Off Street Parking

Potential To Extend (STPP)

Chain Free

End Of Terrace

50ft Rear Garden

Downstairs Shower Room

Close To Fetcham Village

Good Local Schools Near By

EPC Rating E

Set close to Fetcham Village, within walking distance of the local shops and amenities. The house is also well located for the excellent local schools.





This charming property is being offered to market chain free.

Downstairs offers a lounge with a feature fireplace and a useful under stairs cupboard. A door leads through to a bright kitchen overlooking the rear garden with a conservatory and a further door to a shower room.

Stairs from the hall lead to the upstairs landing with three bedrooms.

This house benefits from double glazing and gas central heating throughout.

Outside to the front there is off street parking with side access to a 50ft rear garden.



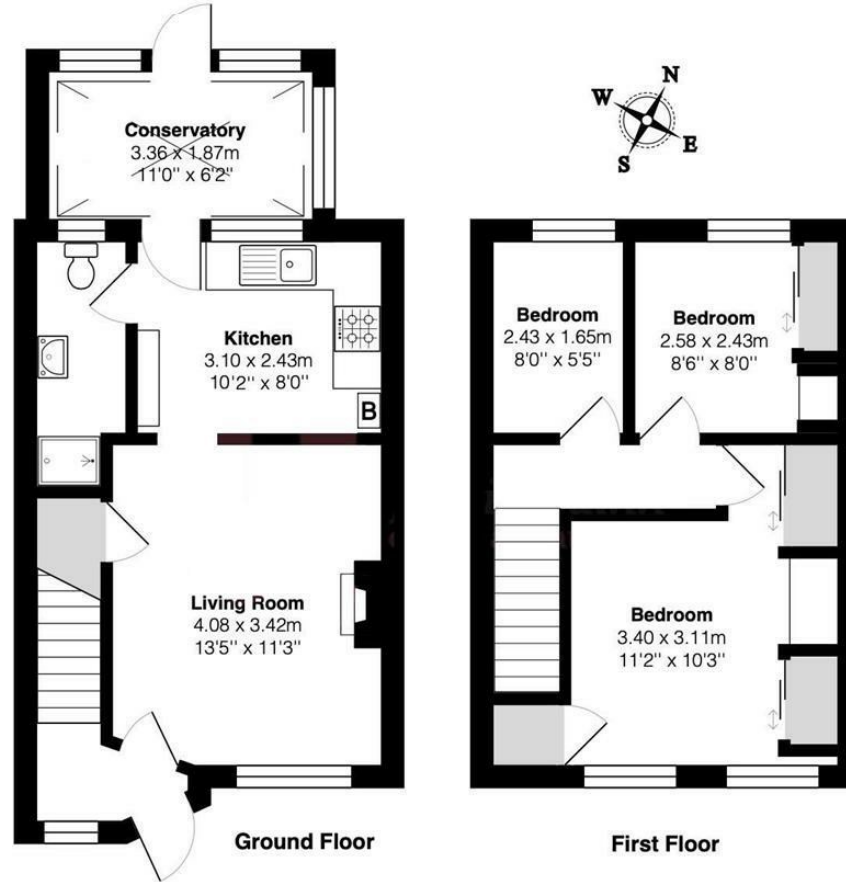

Oswald Road, Fetcham, Leatherhead

Total Area: 67.1 m² ... 722 ft²

FOR ILLUSTRATIVE PURPOSES ONLY.

Whilst every attempt has been made to ensure the accuracy of the floor plan shown, all measurements, positioning, fixtures, features, fittings and any other data shown are an approximate interpretation for illustrative purposes only and are not to scale.

No responsibility is taken for any error, omission, miss-statement or use of data shown.

V&H Homes

01372 221 678

sales@vhhomes.co.uk

www.vhhomes.co.uk

