



Stevens Close, Epsom KT17 4RG

**V&H**  
HOMES

Your local property specialist



## Stevens Close Epsom KT17 4RG

*The maisonette is ideally located just a stone's throw from the town centre, making it easy to enjoy the local amenities, shops, and eateries that Epsom has to offer.*

*Additionally, the property comes with its own parking space, a valuable asset in this bustling area.*

**\*\*CHAIN FREE\*\*** Newly Refurbished First

Floor Maisonette

High Gloss Grey Galley Style Kitchen

Spacious Lounge

Own Parking Space

Large Bedroom with Mirrored Wardrobes

Spacious White Bathroom Suite with bath  
and shower

Long Lease 950 Years Remaining

EPC C Rating

Minutes From Town Centre and Trainline





The newly refurbished bathroom features a modern shower, ensuring a refreshing start to your day.

The double bedroom has large mirrored sliding wardrobes which give ample storage facilities.

Ready to move into immediately, chain free.



# Stevens Close, Epsom, KT17

Approximate Area = 466 sq ft / 43.2 sq m

For identification only - Not to scale

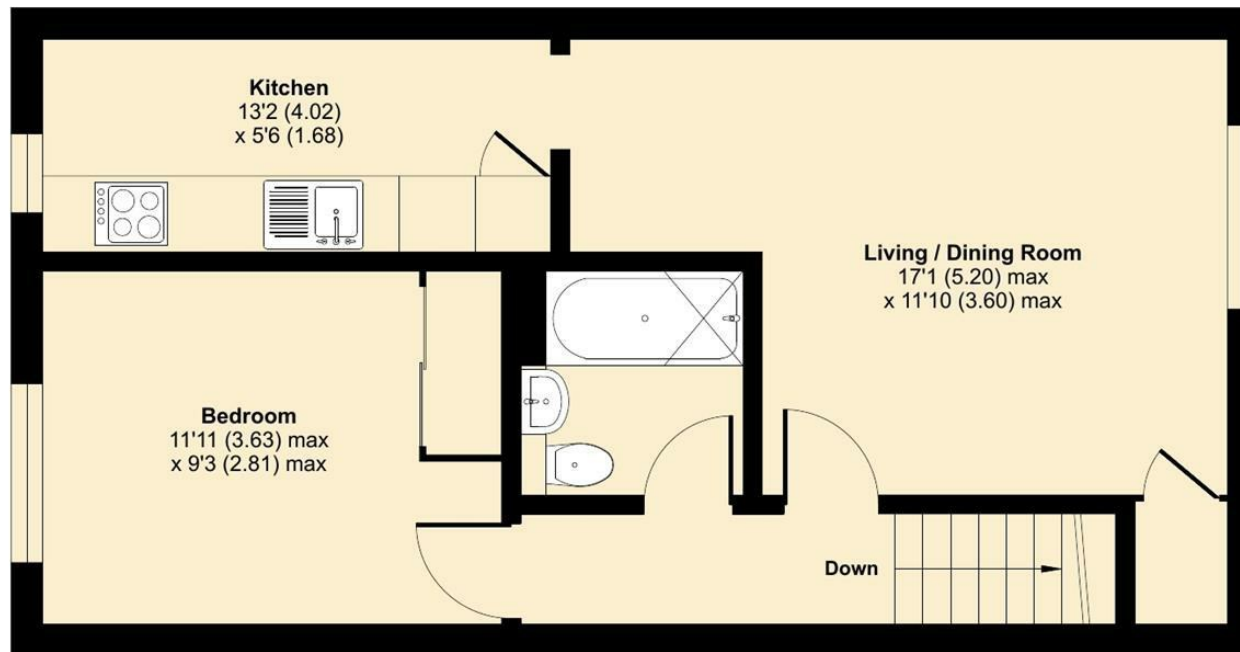

FIRST FLOOR



Floor plan produced in accordance with RICS Property Measurement 2nd Edition, Incorporating International Property Measurement Standards (IPMS2 Residential). © nchecon 2025. Produced for V&H Homes. REF: 1354001



## V&H Homes

01372 221 678

[sales@vhhomes.co.uk](mailto:sales@vhhomes.co.uk)

[www.vhhomes.co.uk](http://www.vhhomes.co.uk)



Your local property specialist