



Ashdown Road, Epsom KT17 3PL

V&H
HOMES

Your local property specialist

RENTALS

Ashdown Road
Epsom KT17 3PL

Detached House

Four Bedrooms

Three Bathrooms

Three Receptions

Off Street parking

Rear Garden

Unfurnished

Energy Performance Certificate D

Council Tax Band G



V&H
HOMES





Ashdown Road, Epsom, KT17

APPROX. GROSS INTERNAL FLOOR AREA 2114 SQ FT 196.4 SQ METRES (EXCLUDES RESTRICTED HEAD HEIGHT & BOILER ROOM / INCLUDES GARAGE)

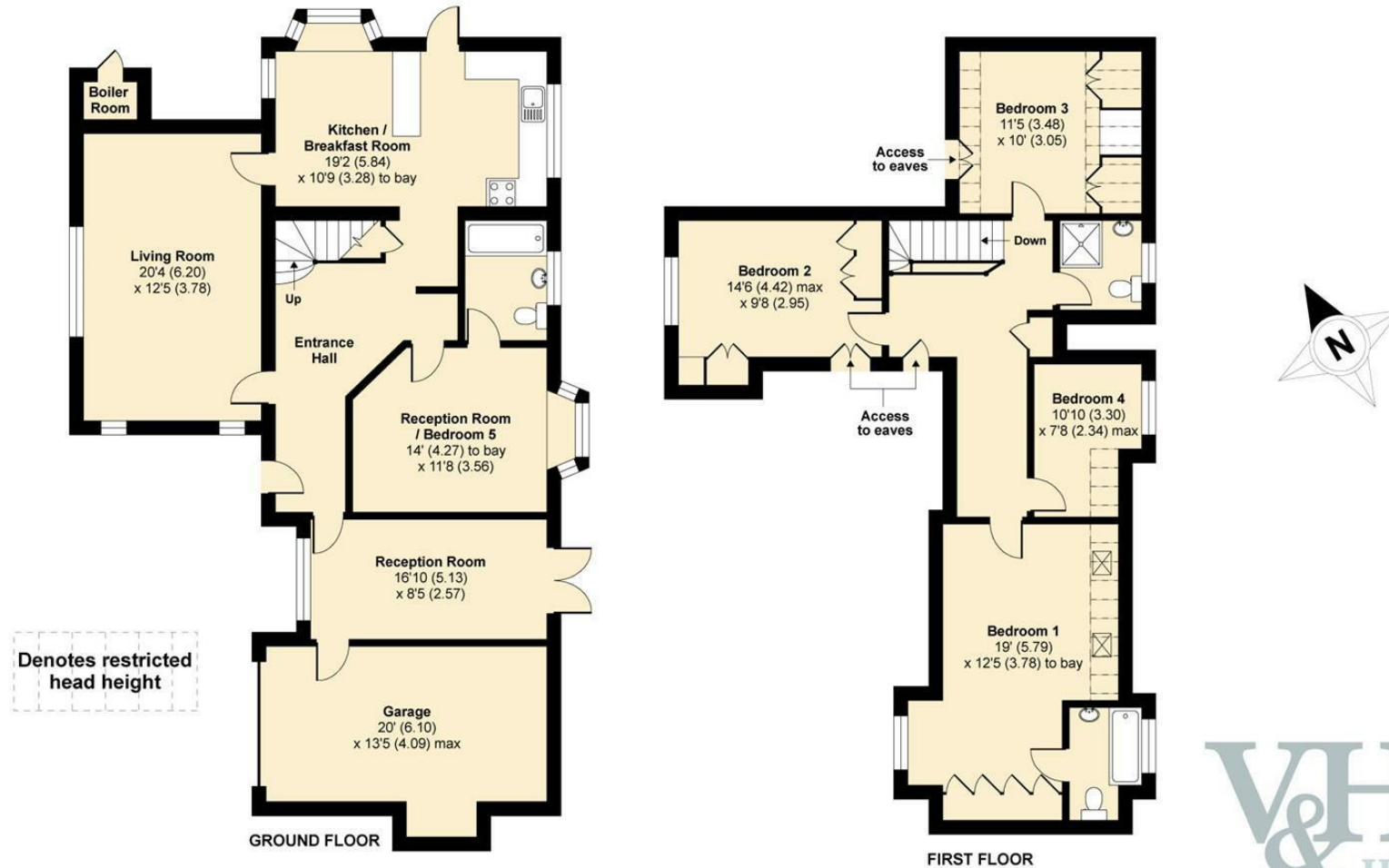

Whilst every attempt has been made to ensure the accuracy of the floor plan contained here, measurements of doors, windows and rooms are approximate and no responsibility is taken for any error, omission or misstatement. These plans are for representation purposes only as defined by RICS Code of Measuring Practice and should be used as such by any prospective purchaser. Specifically no guarantee is given on the total square footage of the property if quoted on this plan. Any figure given is for initial guidance only and should not be relied on as a basis of valuation.

Copyright nichecom.co.uk 2018 Produced for V&H Homes REF : 256051

V&H Homes

01372 221 678

sales@vhomes.co.uk

www.vhomes.co.uk

rightmove

Zoopla

PrimeLocation.com

The Property Ombudsman

hometrack

V&H HOMES

Your local property specialist