



Hayton Crescent, Tadworth KT20 5FG

V&H
HOMES

Your local property specialist

Hayton Crescent Tadworth KT20 5FG

A modern, immaculately presented semi-detached family home, situated in a quiet road in Hayton Crescent, Tadworth.

Three Bedroom Semi-Detached House

Spacious Kitchen/Dining Room

Reception Room

Utility and Downstairs WC

Master Bedroom with En-Suite

Garden with Patio

Family Bathroom

Garage and Off Street Parking

Close to Epsom Downs

EPC Rating: B





Downstairs comprises a bright reception room leading to a spacious kitchen/diner with modern appliances, a downstairs WC and utility room.

Upstairs there is a master bedroom with built in storage and an en-suite, plus two further bedrooms and a family bathroom.

The sunny rear garden is in great condition with a large patio area leading to a well kept lawn.

The wide open spaces of Epsom Downs are nearby, whilst locally there is a vast choice of state and independent schools.

Additional benefits include full loft access, garage and allocated parking.

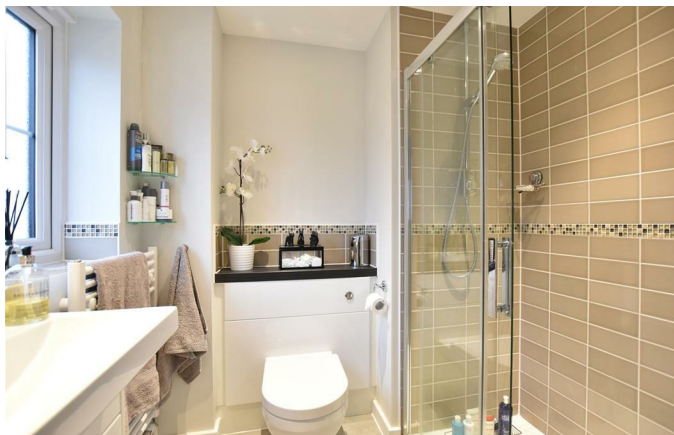

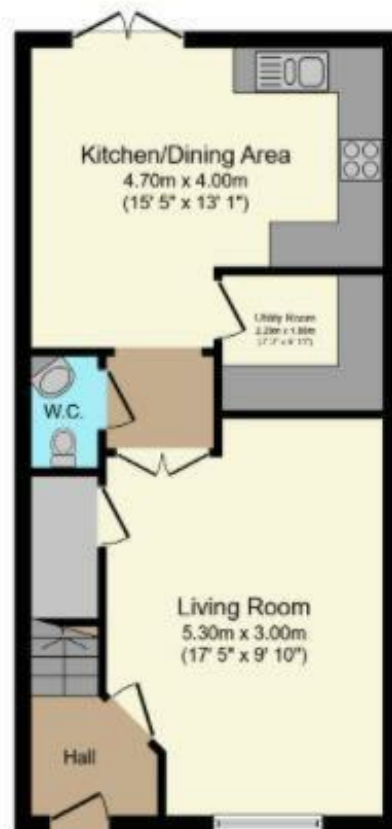

Ground Floor

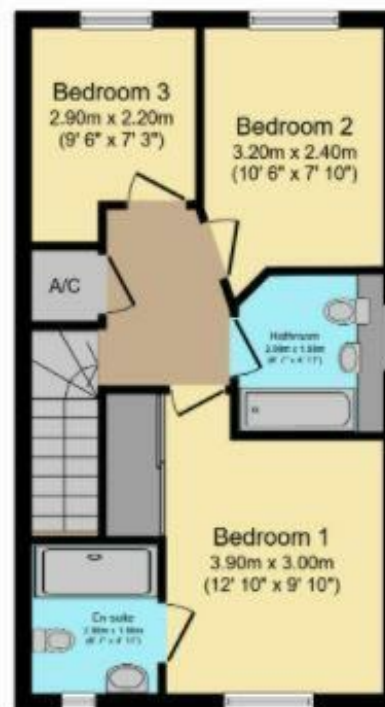

First Floor



Garage

Total floor area 107.0 sq. m. (1,152 sq. ft.) approx

This floor plan is for illustrative purposes only. It is not drawn to scale. Any measurements, floor areas (including any total floor area), openings and orientation are approximate. No details are guaranteed, they cannot be relied upon for any purpose and they do not form part of any agreement. No liability is taken for any error, omission

V&H Homes

01372 221 678

sales@vhhomes.co.uk

www.vhhomes.co.uk

rightmove

Zoopla

PrimeLocation.com

The Property Ombudsman

hometrack

V&H HOMES

Your local property specialist