



Pound Court, Ashted KT21 1RN

V&H
HOMES

Your local property specialist

Pound Court
Ashted KT21 1RN

Terraced House
Two Bedrooms
Lounge/Dining Room
Fitted Kitchen
Fitted Bathroom
Garden
Council Tax Band E
EPC Rating C
Unfurnished





GROUND FLOOR

APPROX. 42.4 SQ. METRES (456.8 SQ. FEET)

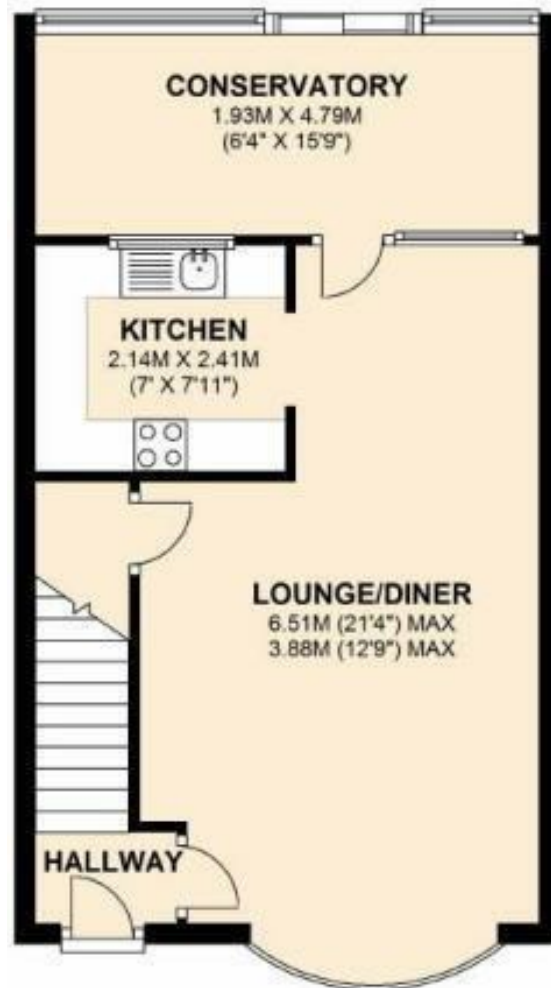

FIRST FLOOR

APPROX. 31.5 SQ. METRES (339.2 SQ. FEET)

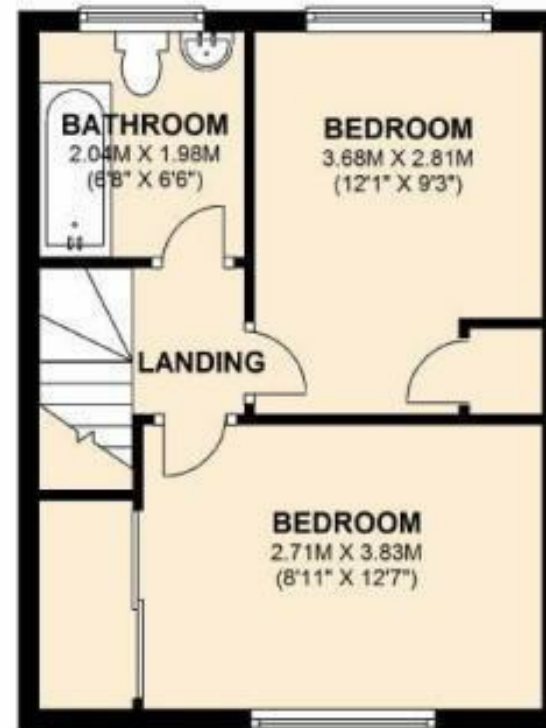

TOTAL AREA: APPROX. 74.0 SQ. METRES (796.0 SQ. FEET)

V&H Homes

01372 221 678

sales@vhhomes.co.uk

www.vhhomes.co.uk

rightmove

Zoopla

PrimeLocation.com

The Property Ombudsman

hometrack

V&H HOMES

Your local property specialist