



Agates Lane, Ashted KT21 2ND

V&H
& HOMES

Your local property specialist

Agates Lane Ashted KT21 2ND

This substantial double fronted period property is located in the desirable 'Lanes' of Ashted. The house boasts ample accommodation and five double bedrooms over three floors alongside high ceilings and character features throughout.

Substantial Period Property

'Lanes' Area of Ashted

Five Double Bedrooms

Three Bathrooms

Three Floors

Double Aspect Drawing Room

Bespoke Open Plan Kitchen

1 Mile From Station

Superb Private & State Schools

Character Features Throughout

The house is approximately one mile from Ashted station which offers trains to London Bridge & Waterloo in approximately 40 minutes. There are a variety of highly rated independent and state schools in the area.





On entering the house, an elevated grand entrance hall leads to the substantial double aspect drawing room. The expansive bespoke kitchen / dining room is triple aspect and offers external access. The ground floor of this outstanding property also benefits from an additional reception room and a useful cloakroom.

The first floor landing leads to the large master bedroom with en-suite four-piece bathroom, charming bay window and feature fireplace. There are two further double bedrooms on this floor, and a family bathroom. The top floor of the property offers two double bedrooms, one with en-suite shower room, and a landing / study area.

Externally there is gravelled off street parking for three vehicles and gates leading to the delightful patio and garden. The garden is mainly laid to lawn and is secluded.

Viewings of this excellent period property in an outstanding location are highly recommended.





GROUND FLOOR
APPROX. FLOOR
AREA 91.0 SQ.M.
(979 SQ.FT.)



1ST FLOOR
APPROX. FLOOR
AREA 73.9 SQ.M.
(795 SQ.FT.)

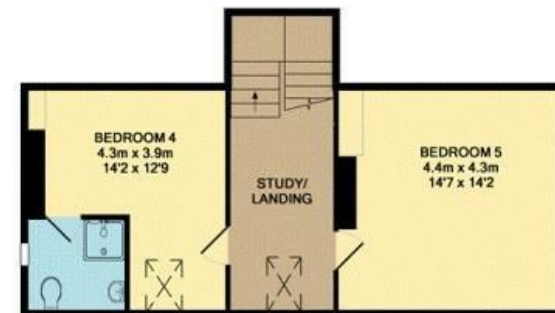

2ND FLOOR
APPROX. FLOOR
AREA 46.1 SQ.M.
(496 SQ.FT.)

TOTAL APPROX. FLOOR AREA 210.9 SQ.M. (2270 SQ.FT.)

Whilst every attempt has been made to ensure the accuracy of the floor plan contained here, measurements of doors, windows, rooms and any other items are approximate and no responsibility is taken for any error, omission, or mis-statement. This plan is for illustrative purposes only and should be used as such by any prospective purchaser. The services, systems and appliances shown have not been tested and no guarantee as to their operability or efficiency can be given.
Made with Metropix S2017

V&H Homes

01372 221 678

sales@vhhomes.co.uk

www.vhhomes.co.uk

rightmove

Zoopla

PrimeLocation.com

The Property Ombudsman

hometrack

V&H HOMES

Your local property specialist