

TURNERS



Birchwood Close, Morden, SM4
£1,300 Per Month

020 8687 9787 | turnersproperty.com | 105 London Road, Morden, Surrey, SM4 5HP

TURNERS





Full Description

The referencing would require tenants to earn 30 times the monthly rent. Which is £39,000 per annum.

LOCATION! LOCATION! WITH GREAT TRANSPORTATION LINKS. This ground floor one bedroom apartment is located in a private development within 0.25 of mile of Morden tube station and bus links and High Street. Features to note are security entry phone, gas central heating and allocated parking. The accommodation comprises of entrance hall, lounge/diner 16'7 max x 14'3 max, fitted kitchen 9 x 8, bathroom 5'9 x 7'7 and double bedroom 11' x 10'11.



Key Features

- GROUND FLOOR
- UNFURNISHED
- HEART OF MORDEN
- TUBE STATION WITHIN MINUTES
- GREAT ACCOMMODATION
- PARKING
- AVAILABLE NOW
- No pets

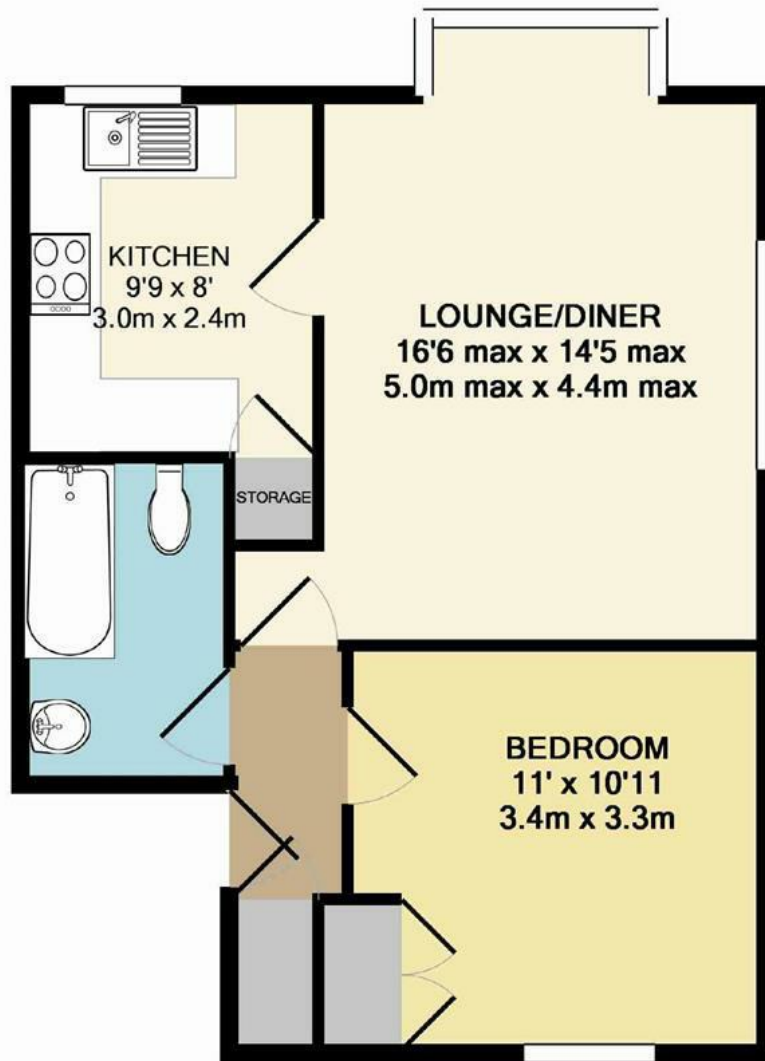

TOTAL APPROX. FLOOR AREA 488 SQ.FT. (45.3 SQ.M.)

Whilst every attempt has been made to ensure the accuracy of the floor plan contained here, measurements of doors, windows, rooms and any other items are approximate and no responsibility is taken for any error, omission, or mis-statement. This plan is for illustrative purposes only and should be used as such by any prospective purchaser. The services, systems and appliances shown have not been tested and no guarantee as to their operability or efficiency can be given

Made with Metropix ©2016

| Energy Efficiency Rating | | |
|---|-------------------------|-----------|
| | Current | Potential |
| Very energy efficient - lower running costs | | |
| (92 plus) A | | |
| (81-91) B | | |
| (69-80) C | 71 | 76 |
| (55-68) D | | |
| (39-54) E | | |
| (21-38) F | | |
| (1-20) G | | |
| Not energy efficient - higher running costs | | |
| England & Wales | EU Directive 2002/91/EC | |

Birchwood Close, Morden, SM4

£1,300 Per Month

020 8687 9787 | turnersproperty.com | 105 London Road, Morden, Surrey, SM4 5HP

TURNERS

