

TURNERS



Chipstead Close, Sutton, SM2
£210,000 Leasehold

020 8687 9787 | turnersproperty.com | 105 London Road, Morden, Surrey, SM4 5HP

TURNERS





Full Description

Nestled in a quiet, highly sought-after development on Chipstead Close, this ground-floor 1 bedroom flat offers an excellent opportunity for first-time buyers, investors or those looking to downsize, all with the added benefit of no onward chain, complete with residents' parking.

This home features a bright living space and a comfortable double bedroom. Fitted kitchen and 3 piece bathroom suite.

Belmont railway station is approximately a 10 minute walk away, providing reliable services into central London and beyond. Sutton mainline station is also within easy reach, at around a 15 minute walk. Making this home ideal for commuters seeking quick links to London Victoria, London Bridge and other major destinations.

Residents will also appreciate the convenience of being just a short stroll from local amenities, shops and cafés, while enjoying the quiet cul-de-sac setting.



Key Features

- 1 bedroom
- Ground floor
- No onward chain
- Council tax band B 1452.99 before discounts
- Good order
- South Sutton
- Popular Development
- Electric Heating
- EPC rating D

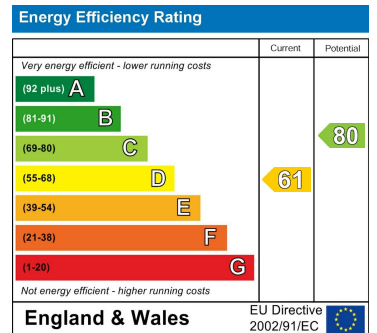
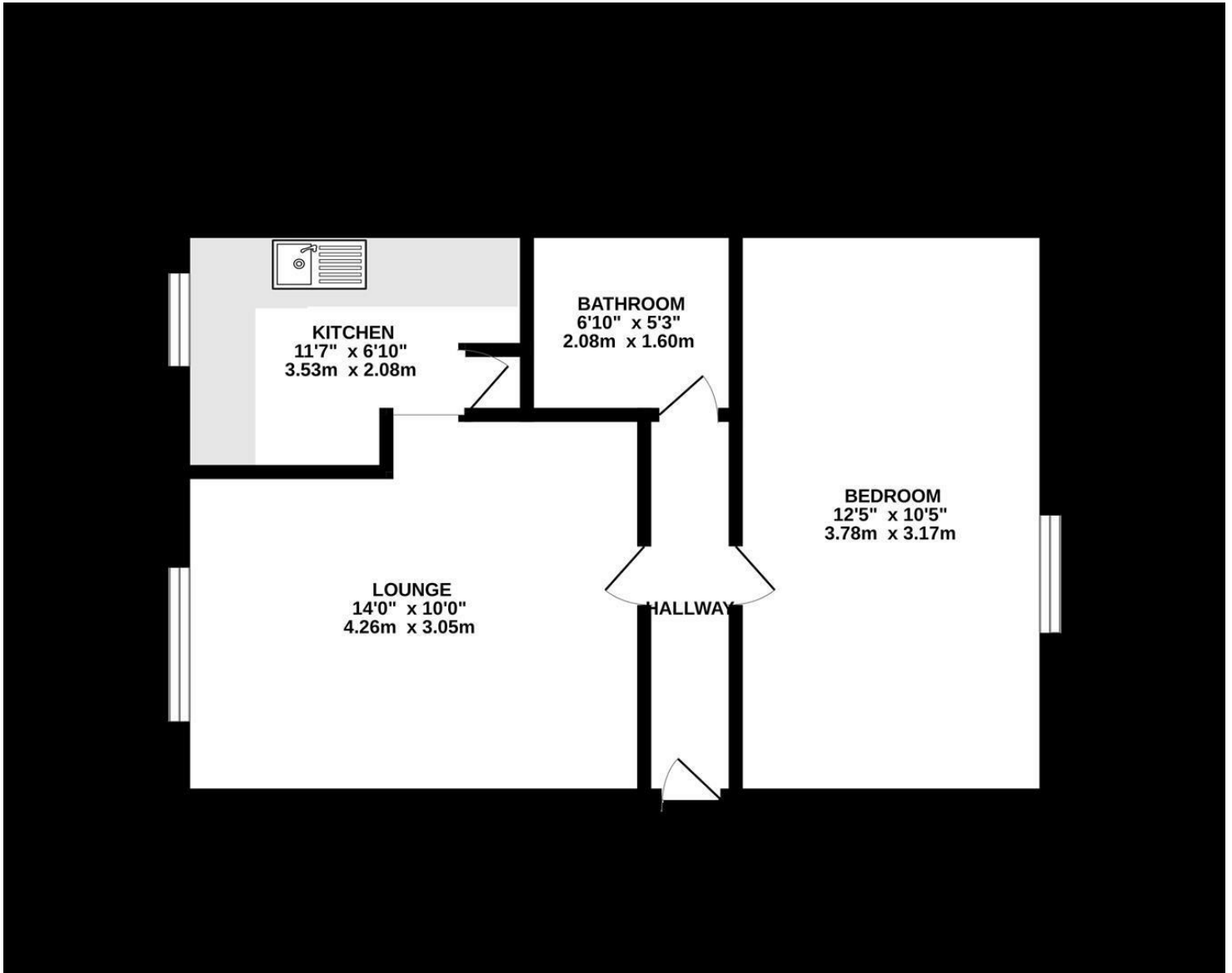

Chipstead Close, Sutton, SM2

£210,000 Leasehold

020 8687 9787 | turnersproperty.com | 105 London Road, Morden, Surrey, SM4 5HP

