

TURNERS



3 Palmerston Court, Sutton, SM1
£1,200

020 8687 9787 | turnersproperty.com | 105 London Road, Morden, Surrey, SM4 5HP

TURNERS





Full Description

We are arranging viewings for Monday the 29th of April between 17:00 - 18:00 please email info@turnersproperty.com to book your viewing. The referencing would require tenants to have an income 30 times the monthly rent. Which is £36,000 per annum.

A recently redecorated 1-bedroom ground floor apartment boasting new carpets throughout. Conveniently situated near local shops, bus routes, and within walking distance to Sutton High Street and the overground station. This apartment is currently available and includes a parking space.



Key Features

GROUND FLOOR
384 sq.ft. (35.7 sq.m.) approx.

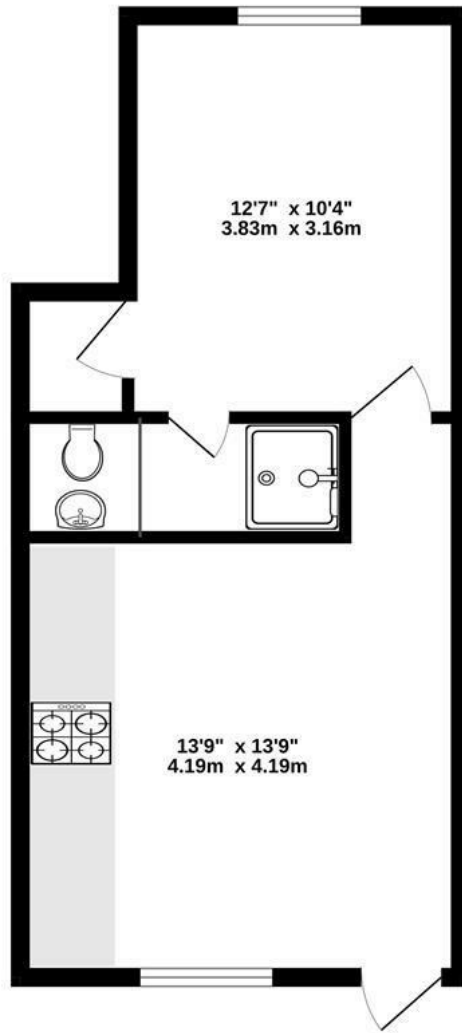

TOTAL FLOOR AREA: 384 sq.ft. (35.7 sq.m.) approx.

Whilst every attempt has been made to ensure the accuracy of the floorplan contained here, measurements of doors, windows, rooms and any other items are approximate and no responsibility is taken for any error, omission or mis-statement. This plan is for illustrative purposes only and should be used as such by any prospective purchaser. The services, systems and appliances shown have not been tested and no guarantee as to their operability or efficiency can be given.
Made with Metropix ©2024.

Energy Efficiency Rating		
	Current	Potential
Very energy efficient - lower running costs		
(92 plus) A		
(81-91) B		
(69-80) C		
(55-68) D	59	59
(39-54) E		
(21-38) F		
(1-20) G		
Not energy efficient - higher running costs		
England & Wales	EU Directive 2002/91/EC	

3 Palmerston Court, Sutton, SM1

£1,200

020 8687 9787 | turnersproperty.com | 105 London Road, Morden, Surrey, SM4 5HP

