

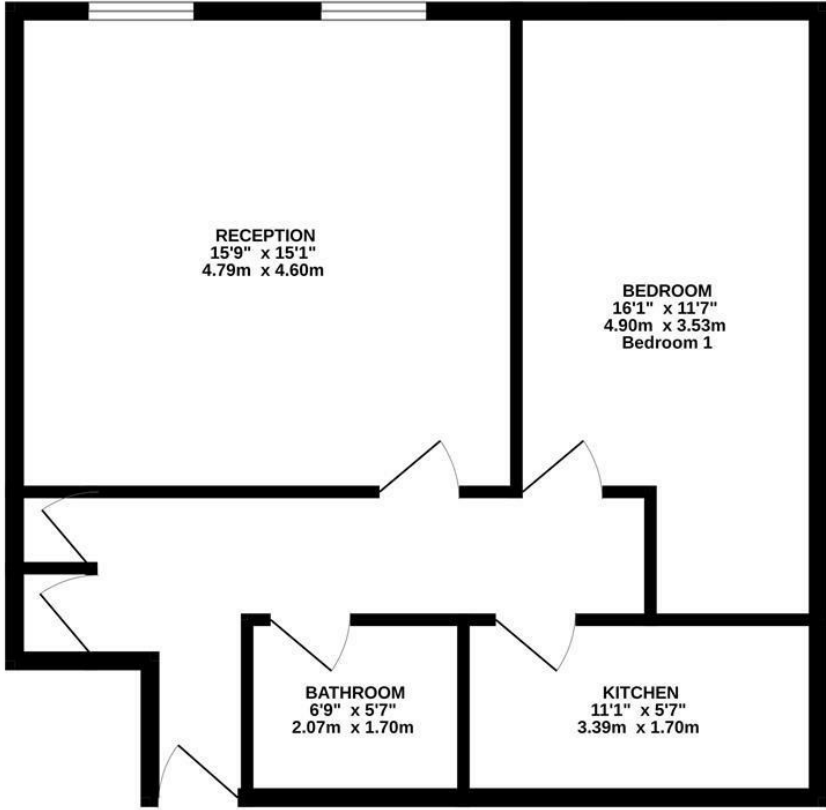

TOP FLOOR
603 sq.ft. (56.1 sq.m.) approx.



TOTAL FLOOR AREA : 603 sq.ft. (56.1 sq.m.) approx.
Whilst every attempt has been made to ensure the accuracy of the floorplan contained here, measurements of doors, windows, rooms and any other items are approximate and no responsibility is taken for any error, omission or mis-statement. This plan is for illustrative purposes only and should be used as such by any prospective purchaser. The services, systems and appliances shown have not been tested and no guarantee as to their operability or efficiency can be given.
Made with Metropix ©2025

Energy Efficiency Rating		
	Current	Potential
Very energy efficient - lower running costs		
(92 plus) A		
(81-91) B		
(69-80) C		
(55-68) D		
(39-54) E		
(21-38) F		
(1-20) G		
Not energy efficient - higher running costs		
England & Wales	EU Directive 2002/91/EC	



Clover Court , 44 Mulgrave Road, Sutton, SM2
£1,300

0208 687 9787 | turnersproperty.com | 105 London Road, Morden, Surrery, SM4 5HP

Clover Court , 44 Mulgrave Road, Sutton, SM2
£1,300

0208 687 9787 | turnersproperty.com | 105 London Road, Morden, Surrery, SM4 5HP



[Full description](#)

Key Features

- 1 bedroom
- Top floor
- South Sutton
- Generous sized rooms
- Recently redorcarated
- Allocated parking
- Epc rating
- Double glazing
- Gas Central heating