

TURNERS



Rothsay Avenue, London, SW20

£400,000 Leasehold

020 8687 9787 | turnersproperty.com | 105 London Road, Morden, Surrey, SM4 5HP

TURNERS





Full Description

A delightful and purpose-built, this two-bedroom period ground-floor maisonette is nestled in a sought-after cul-de-sac. Featuring a private garden, it offers the perfect space for outdoor relaxation. On-street permit parking is also available.

The interior has been well maintained, providing well-proportioned accommodation throughout. With a long 932-year lease and low outgoings, this property is an excellent investment.

Ideally situated in a desirable area, the maisonette offers easy access to local amenities, parks, and excellent transport links. Wimbledon Chase Thameslink station is just a short distance away, while the many shops, schools, and recreational facilities of Wimbledon, SW20, are also within easy reach.

Don't miss the opportunity to make this charming period maisonette your new home. Contact us today to arrange a viewing!



Key Features

- 932 years remaining on the lease
- No upward chain
- Residents parking
- Rear Garden
- Ground Floor
- Pepper corn ground rent
- Next to Wimbledon

GROUND FLOOR
522 sq.ft. (48.5 sq.m.) approx.

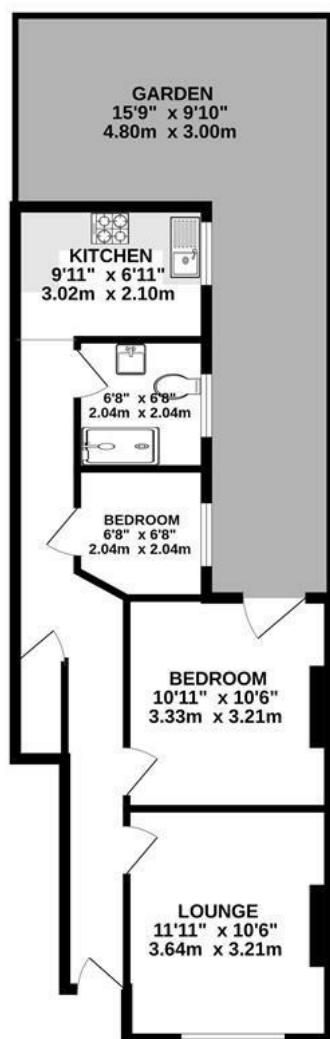

TOTAL FLOOR AREA: 522 sq.ft. (48.5 sq.m.) approx.

Whilst every attempt has been made to ensure the accuracy of the floorplan contained here, measurements of doors, windows, rooms and any other items are approximate and no responsibility is taken for any error, omission or mis-statement. This plan is for illustrative purposes only and should be used as such by any prospective purchaser. The services, systems and appliances shown have not been tested and no guarantee as to their operability or efficiency can be given.
Made with Metropix ©2025

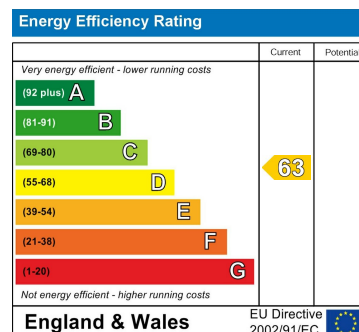

Rothesay Avenue, London, SW20

£400,000 Leasehold

020 8687 9787 | [turnersproperty.com](https://www.turnersproperty.com) | 105 London Road, Morden, Surrey, SM4 5HP

TURNERS

