



Lilburne Avenue, Norwich, NR3

The ground floor flat features an entrance hall, kitchen, bathroom, and a generous living room. There are two double bedrooms, with the master benefiting from built in wardrobes, alongside numerous storage cupboards for added convenience. Externally, the property enjoys its own private garden, offering a rare and desirable feature in this location!

Offers In Excess Of £125,000

GROUND FLOOR
584 sq.ft. (54.2 sq.m.) approx.

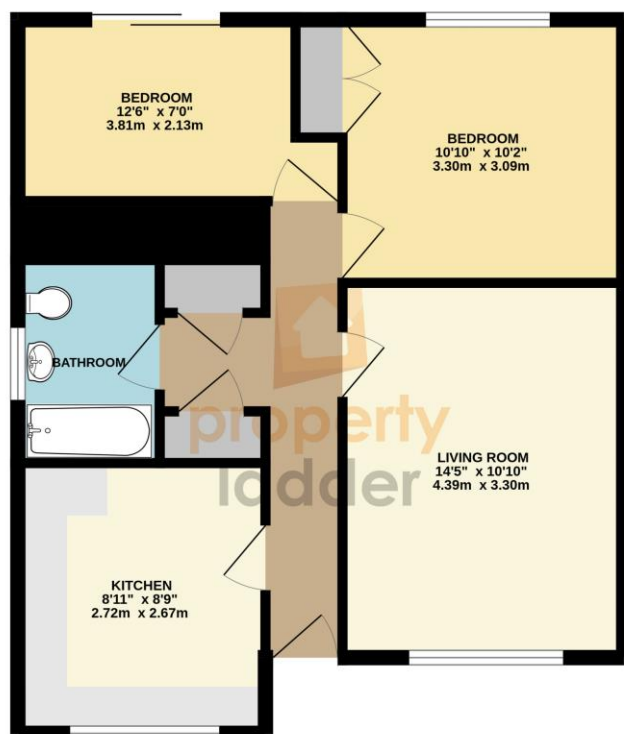

Room Dimensions

Entrance Hall

Kitchen

8'11 x 8'9 (2.72m x 2.67m)

Living Room

14'5 x 10'10 (4.39m x 3.30m)

Bathroom

Master Bedroom

14'5 x 10'10 (4.39m x 3.30m)

Bedroom 12'6 x 7' (3.81m x 2.13m)

| Score | Energy rating | Current | Potential |
|-------|---------------|---------|-----------|
| 92+ | A | | |
| 81-91 | B | | |
| 69-80 | C | 69 C | 77 C |
| 55-68 | D | | |
| 39-54 | E | | |
| 21-38 | F | | |
| 1-20 | G | | |

Selling your home?

If you are considering selling your home, please contact us for your no obligation free market appraisal.

**BRITISH
PROPERTY
AWARDS**
2023 & 2024

GOLD WINNER
ESTATE AGENT
IN NORWICH
(NR10-16)

98 Crostwick Lane, Spixworth, NR10 3NQ
T 01603 898100
propertyladderonline.com

IMPORTANT NOTICE: Property Ladder, their clients and any joint agents give notice that: 1. They are not authorised to make or give any representations or warranties in relation to the property either here or elsewhere, either on their own behalf or on behalf of their client or otherwise. They assume no responsibility for any statement that may be made in these particulars. These particulars do not form part of any offer or contract and must not be relied upon as statements or representations of fact. 2. Any areas, measurements or distances are approximate. The text, photographs and plans are for guidance only and are not necessarily comprehensive. It should not be assumed that the property has all necessary planning, building regulation or other consents and Property Ladder have not tested any services, equipment or facilities. Purchasers must satisfy themselves by inspection or otherwise.