



Nursery Close, Norwich, NR6 5SL

This ground floor flat in Hellesdon offers a fantastic blend of comfort and convenience, featuring two double bedrooms, a bathroom, a spacious living room and well-appointed kitchen. The properties standout feature is its own private garden, a rare find, boasting a well-maintained lawn, a stylish decking area ideal for outdoor dining, and a handy shed for extra storage. Further benefits include an allocated parking space, with additional visitors' parking available.

Guide Price
£170,000

GROUND FLOOR
495 sq.ft. (46.0 sq.m.) approx.

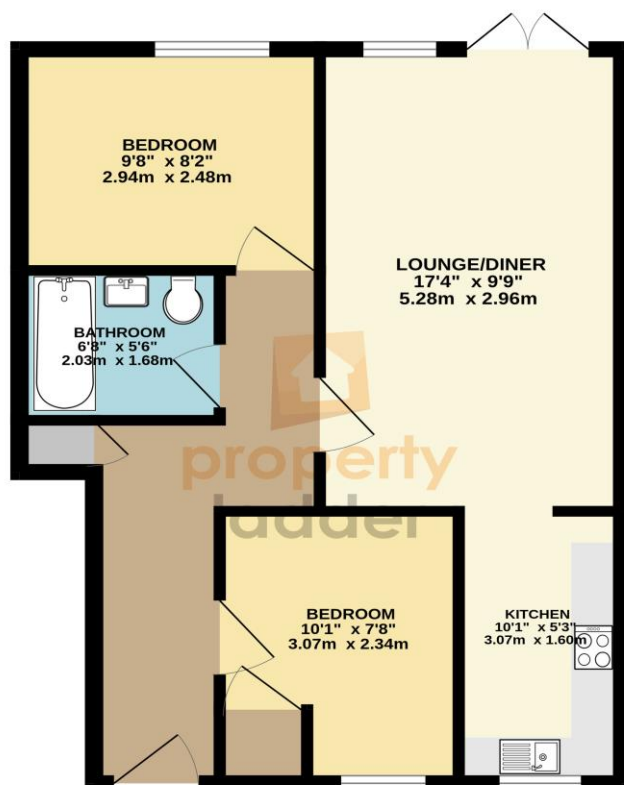

Room Dimensions

Entrance Hall

Lounge/Diner - 17'4 x 9'9 (5.28m x 2.96m)

Bedroom - 9'8 x 8'2 (2.94m x 2.48m)

Bedroom - 10'1 x 7'8 (3.07m x 2.34m)

Kitchen - 10'1 x 5'3 (3.07m x 1.60m)

Bathroom - 6'8 x 5'6 (2.03m x 1.68m)

Selling your home?

If you are considering selling your home please contact us for your no obligation free market appraisal.

Get in touch today!

Tel: 01603 666006



40 Exchange Street, Norwich, Norfolk, NR2 1AX



T 01603 666006

propertyladderonline.com

IMPORTANT NOTICE: Property Ladder, their clients and any joint agents give notice that: 1. They are not authorised to make or give any representations or warranties in relation to the property either here or elsewhere, either on their own behalf or on behalf of their client or otherwise. They assume no responsibility for any statement that may be made in these particulars. These particulars do not form part of any offer or contract and must not be relied upon as statements or representations of fact. 2. Any areas, measurements or distances are approximate. The text, photographs and plans are for guidance only and are not necessarily comprehensive. It should not be assumed that the property has all necessary planning, building regulation or other consents and Property Ladder have not tested any services, equipment or facilities. Purchasers must satisfy themselves by inspection or otherwise.