



## Sprowston Road, Norwich, NR3 4EB

A three bedroom terraced property in popular NR3 offered with no onward chain

**£200,000 - £210,000**



# Temple Road, Norwich, NR3 1ED

A three bedroom terrace property in popular NR3 offered with no onward chain

## Overview

- NR3 MID TERRACE HOUSE
- THREE BEDROOMS
- NO ONWARD CHAIN
- LONG REAR GARDEN
- TWO RECEPTION ROOMS
- ABUNANCE OF POTENTIAL
- PERFECT FIRST HOME
- CLOSE TO LOCAL AMENITIES
- GROUND FLOOR BATHROOM
- USEFUL OUTBUILDING
- MUST BE SEEN!



**“With three bedrooms, two reception rooms and a great garden, this NR3 home is a great option!”**



## OPPORTUNITY KNOCKS IN NR3!

Sold with no onward chain, this North city terrace house offers three bedrooms, two reception rooms, a long stretching rear garden and an abundance of potential for anybody looking to put their own personal touch on a home!

Situated amongst a range of nearby amenities, this chain free terrace home comprises of a living room, dining room, kitchen, downstairs shower room and three bedrooms.





## Location

The property is located in the ever-popular NR3 postcode, North of the City. This up-and-coming area is a prime location for new independent shops, bars and cafés. If these aren't enough, the main City centre of Norwich is approximately 3 miles away. This vibrant regional capital, includes many unique shops, cafes, bars, high end shopping and the diverse Norwich market. You will find a modern cultural feel with beautiful heritage, and dynamic nightlife as well as two cathedrals and the stunning Norwich Castle with its impressive architecture and history.

There are great transport links from NR3 into Norwich City Centre both to Norwich Bus Station and Norwich Train Station. Direct train services to London and the North Norfolk Coast are available



## Directions

Leave Norwich heading north Sprowston Road. The property can be found on the right hand side, before the supermarket and is identified by our for sale board.

GROUND FLOOR  
384 sq.ft. (35.7 sq.m.) approx.

1ST FLOOR  
347 sq.ft. (32.3 sq.m.) approx.

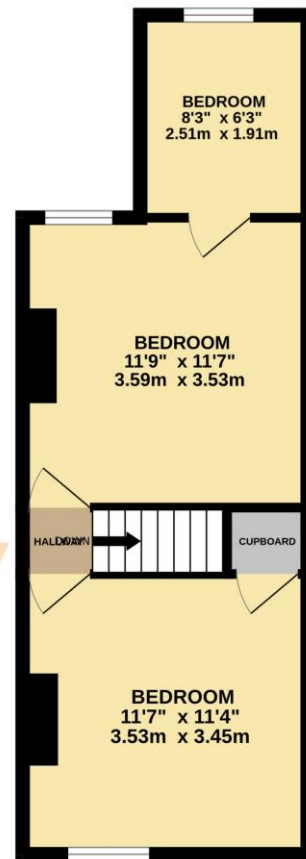
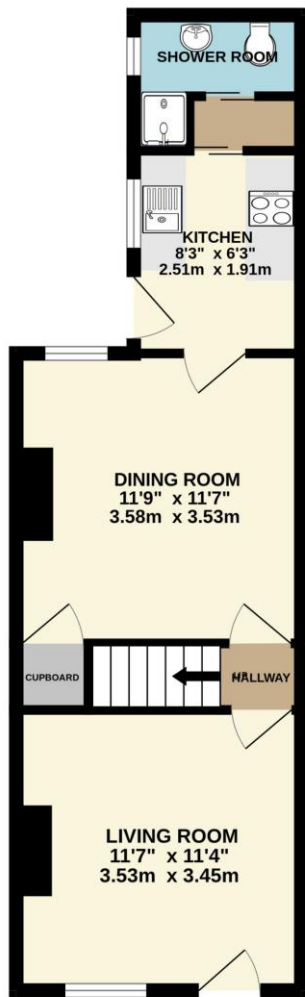

TOTAL FLOOR AREA : 732 sq.ft. (68.0 sq.m.) approx.

Whilst every attempt has been made to ensure the accuracy of the floorplan contained here, measurements of doors, windows, rooms and any other items are approximate and no responsibility is taken for any error, omission or mis-statement. This plan is for illustrative purposes only and should be used as such by any prospective purchaser. The services, systems and appliances shown have not been tested and no guarantee as to their operability or efficiency can be given.  
Made with Metropix ©2023

propertyladder 

## Selling your home?

If you are considering selling your home please contact us for your no obligation free market appraisal.

Get in touch today!

Tel: 01603 666006

FULL EPC AVAILABLE UPON REQUEST



40 Exchange Street, Norwich, Norfolk, NR2 1AX



**T 01603 666006**

propertyladderonline.com

IMPORTANT NOTICE: Property Ladder, their clients and any joint agents give notice that: 1. They are not authorised to make or give any representations or warranties in relation to the property either here or elsewhere, either on their own behalf or on behalf of their client or otherwise. They assume no responsibility for any statement that may be made in these particulars. These particulars do not form part of any offer or contract and must not be relied upon as statements or representations of fact. 2. Any areas, measurements or distances are approximate. The text, photographs and plans are for guidance only and are not necessarily comprehensive. It should not be assumed that the property has all necessary planning, building regulation or other consents and Property Ladder have not tested any services, equipment or facilities. Purchasers must satisfy themselves by inspection or otherwise.