



New Build, Cromwell Close, Cromer
£625,000





New Build, Cromwell Close

Cromer

This stunning three-bedroom bespoke new build detached bungalow, crafted by renowned local developers, enjoys an enviable position within the highly sought-after seaside town of Cromer, just a short stroll from the vibrant town centre and picturesque beach. Thoughtfully designed and impeccably finished, the property offers spacious, light-filled accommodation throughout. At the heart of the home lies a striking kitchen/diner, complete with high-end built-in appliances and a stylish, modern finish, ideal for both everyday living and entertaining. The adjoining utility room adds practicality, while the generously proportioned lounge features elegant French doors that open onto the rear garden, seamlessly blending indoor and outdoor living. The beautifully appointed family bathroom includes a separate shower, and the main bedroom is further enhanced by a luxurious en-suite shower room.

Built to a high specification, this home boasts a multi-zone underfloor heating system with independent thermostatic controls in each room, ensuring comfort and efficiency all year round. The interiors are bathed in natural light thanks to well-positioned windows and a thoughtful layout, while outside, the generous plot offers attractive side and rear gardens, both benefiting from a sunny southerly aspect that captures sunlight throughout the day and into the evening. The rear garden offers a peaceful retreat, perfect for relaxing or entertaining. Additionally, the property includes a garage with power and lighting, as well as a gravelled driveway to the front, providing off-road parking for multiple vehicles. Not an opportunity to be missed! Call Millers to view.





- Newly Constructed
- Bespoke Detached Bungalow
- Three Bedrooms
- Bathroom & En-Suite Shower Room to Main Bedroom
- Impressive Kitchen/Diner
- Utility Room
- Multi-Zone Underfloor Heating System
- Finished to an Impressive Specification
- Highly Sought-After Location
- Generous Garden, Garage & Off-Road Parking

DRAFT DETAILS, SUBJECT TO CHANGE.



Approx Gross Internal Area
134 sq m / 1437 sq ft

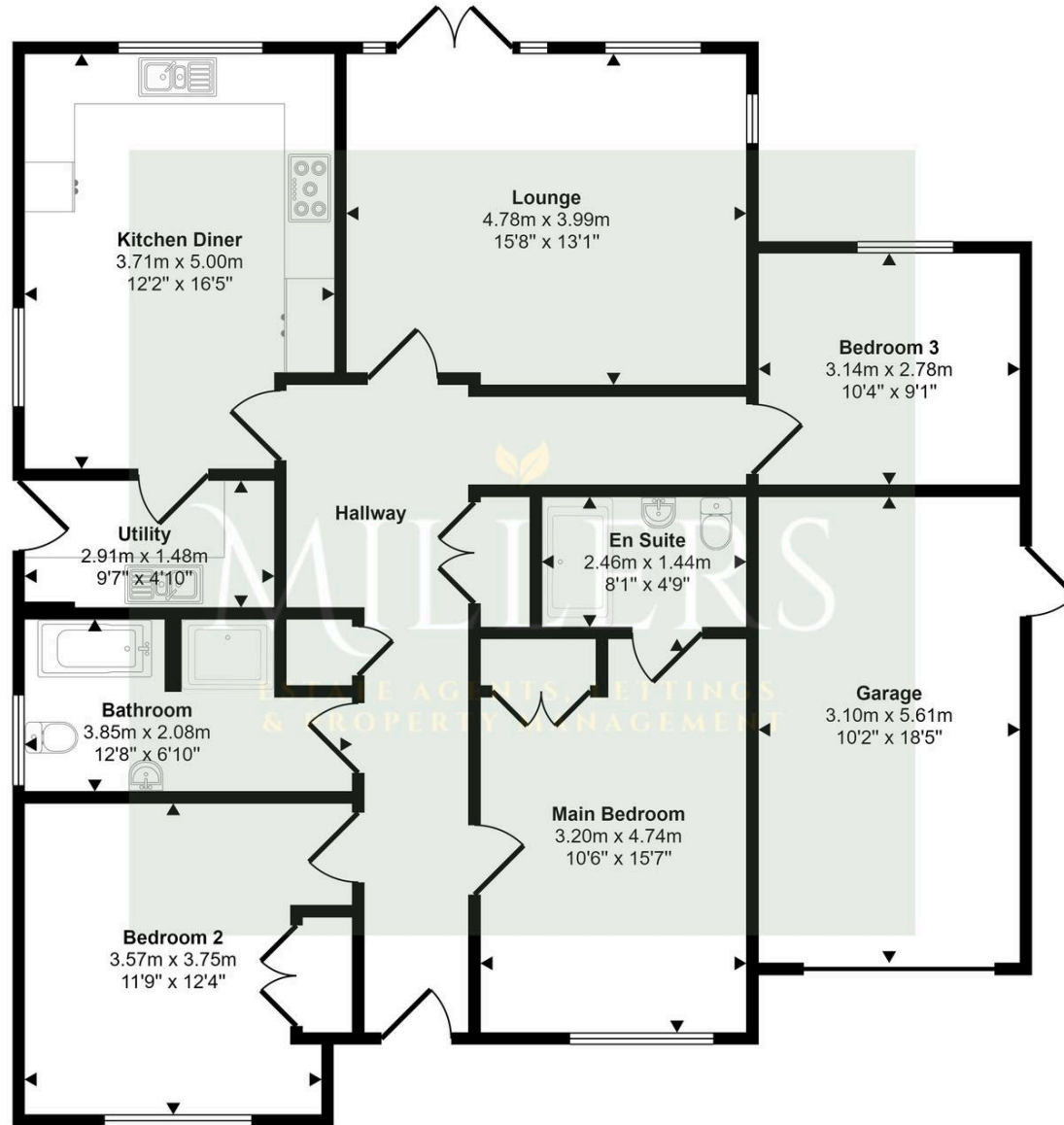

Floorplan

This floorplan is only for illustrative purposes and is not to scale. Measurements of rooms, doors, windows, and any items are approximate and no responsibility is taken for any error, omission or mis-statement. Icons of items such as bathroom suites are representations only and may not look like the real items. Made with Made Snappy 360.

