

9 Mitford Place Leeds



2 Bedroom House - Terraced £125,000

69 Lower Wortley Road
Wortley
Leeds
West Yorkshire
LS12 4SL
Tel: 0113 231 1033
Fax: 0113 203 8333

Web Site
www.kathwells.com

email
sales@kathwells.com

9 Mitford Place, Armley, Leeds, West Yorkshire, LS12 1NH

GROUND FLOOR:

Living Room:



Access via a part glazed front entrance door, fireplace set into the chimney breast, ceiling coving, central heating radiator, television point, stairs rising to the first floor

Fitted Kitchen:

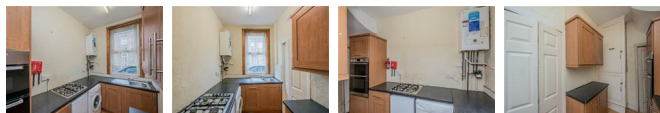

Double glazed window, a range of fitted cabinets, work surfaces, eye level electric oven / grill, gas hob, plumbing for an automatic washing machine, space for a fridge / freezer, stainless steel sink and drainer, access to the cellars

Cellars:

A useful storage area accessed from the kitchen

FIRST FLOOR:

Landing:

Access to the first floor accommodation, stairs rising to the second floor

Bedroom One:



Double glazed window, central heating radiator, original fireplace, a good sized double bedroom

Bathroom / WC:



Double glazed window, a three piece suite comprising of a panelled bath with an electric shower above, wash basin, low flush WC, central heating radiator

SECOND FLOOR:

Bedroom Two:



Double glazed window, central heating radiator

EPC Link:

<https://find-energy-certificate.service.gov.uk/energy-certificate/8604-6296-8129-8196-0113>

Council Tax & EPC Rating:

Council Tax Band: A / EPC Rating: E

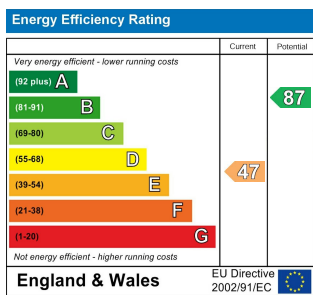

Ground Floor

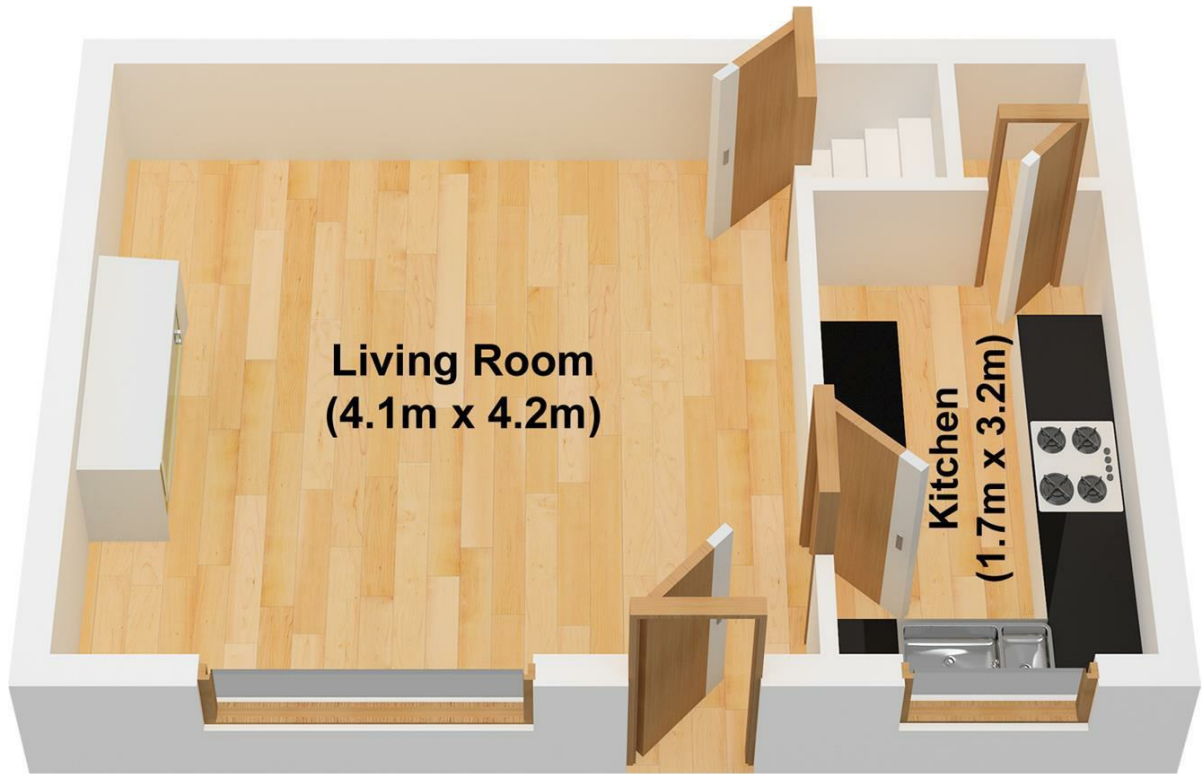

First Floor

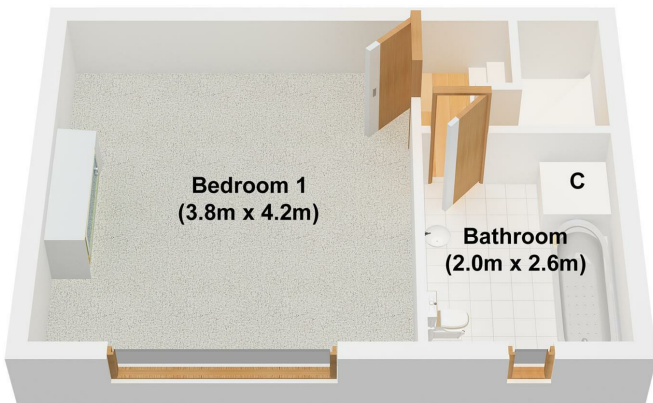

Second Floor

