



# 21 Norman Street

, Leicester, LE3 0BA

Offers Over £185,000

This two bedroom mid terraced house is up for sale with no chain and is situated in a prime location near Leicester City Centre. It is perfect for first time buyers and investors alike. The property boasts an entrance hall, lounge, dining room, and kitchen on the ground floor. The first floor comprises of two double bedrooms and a fully fitted three piece bathroom suite. Additionally, the property features low maintenance front & rear gardens, gas central heating, and UPVC double glazing throughout. Don't miss out on this fantastic opportunity!

- No chain
- Good buy to let Investment
- ideal first time purchase
- Two double bedrooms
- Two Reception rooms
- Rear Kitchen
- Large Family Bathroom
- New Boiler

### Viewing

Please contact our Berkley Leicester Office on 0116 2544755 if you wish to arrange a viewing appointment for this property or require further information.



# Floor Plan

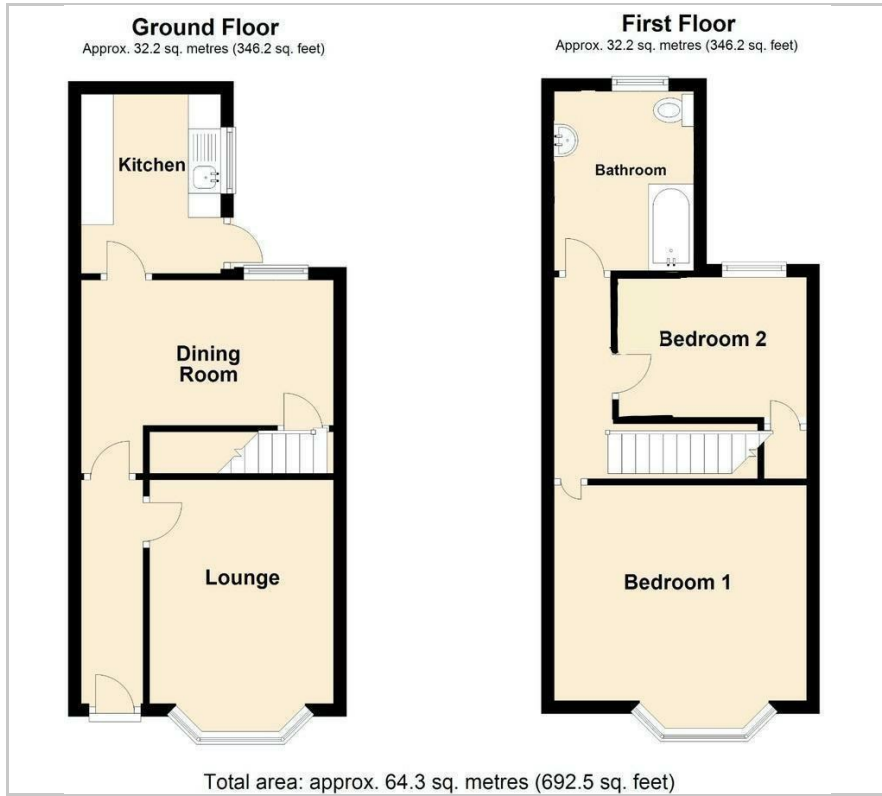

# Area Map



# Energy Efficiency Graph

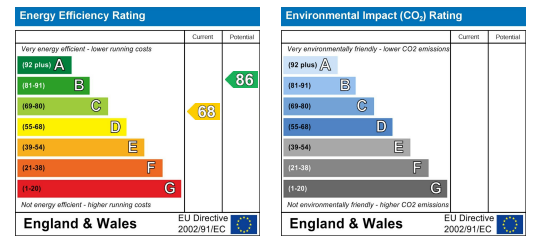

These particulars, whilst believed to be accurate are set out as a general outline only for guidance and do not constitute any part of an offer or contract. Intending purchasers should not rely on them as statements of representation of fact, but must satisfy themselves by inspection or otherwise as to their accuracy. No person in this firm's employment has the authority to make or give any representation or warranty in respect of the property.

75 Hinckley Road, West End, Leicester, Leicestershire, LE3 0TD  
**Tel:** 0116 2544755 **Email:** info@berkleystates.co.uk **berkleystates.co.uk**