



114 Hopefield Road

, Leicester, LE3 2BL

Asking Price £185,000

Discover this charming Victorian terrace house featuring two double bedrooms and a delightful bay front, situated on the sought-after Hopefield Road in West End. This property is available with no upward sales chain, making it an ideal opportunity for first-time buyers or those looking for a buy-to-let investment. The well-designed layout includes inviting front and rear reception rooms, a functional kitchen, two spacious bedrooms, and a newly renovated bathroom. At the back, you'll find a cozy courtyard along with two sturdy brick outbuildings. Don't miss out—contact us today to schedule your viewing!

- TWO BEDROOMS
- VICTORIAN TERRACE
- TWO RECEPTION ROOMS
- CONVENIENT LOCATION
- GREAT STARTER HOME
- GREAT BUY TO LET
- NO UPWARDS SALES CHAIN
- WEST END LOCATION
- BRAND NEW BATHROOM

Viewing

Please contact our Berkley Leicester Office on 0116 2544755 if you wish to arrange a viewing appointment for this property or require further information.

2 1 2 E

Floor Plan

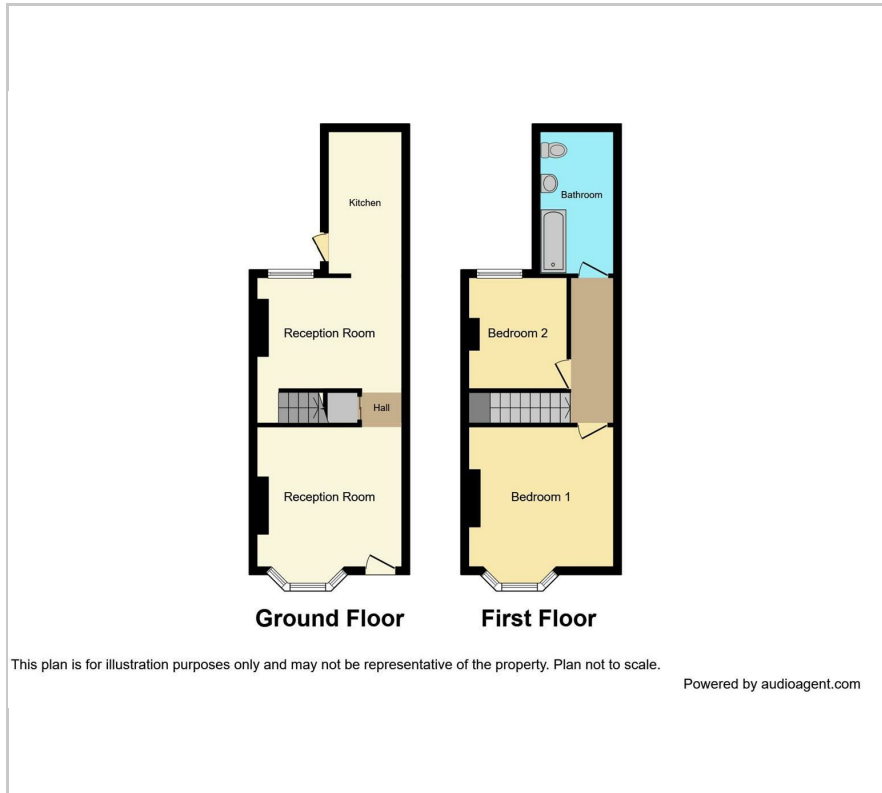

Area Map



Energy Efficiency Graph

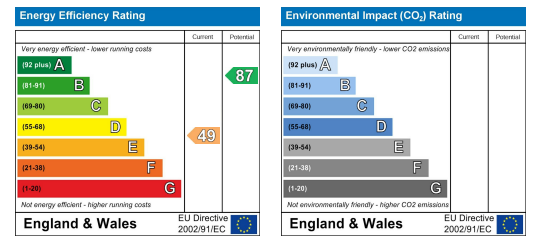

These particulars, whilst believed to be accurate are set out as a general outline only for guidance and do not constitute any part of an offer or contract. Intending purchasers should not rely on them as statements of representation of fact, but must satisfy themselves by inspection or otherwise as to their accuracy. No person in this firm's employment has the authority to make or give any representation or warranty in respect of the property.