



# 31 Claymar Drive

, Newhall, DE11 0LF

## £350,000

This superbly extended three-bedroom home is perfect for a growing family, offering extensive living space and modern amenities. Set on a fantastic corner plot, this property boasts a stunning modern kitchen, three versatile reception rooms, three double bedrooms, an ensuite, a contemporary shower room, a garden room, a garage, and a driveway. There's also excellent potential for further extension, subject to the necessary planning permissions.

Upon entering, you are greeted by a welcoming hallway with stairs to the first floor and doors to the principal rooms. The spacious kitchen features an array of base and wall-mounted units, sleek worktops, and stylish tiling. A breakfast bar with a five-ring gas hob and built-in appliances makes this space ideal for both family meals and entertaining.

The main lounge is generously proportioned, with ample room for a three-piece suite and a striking square bay window. The dining room, located at the rear of the property, boasts sliding glass doors that open onto the garden. The third reception room offers flexible use as a home office or an additional ground-floor bedroom.

Upstairs, you will find three well-appointed double bedrooms. The master bedroom includes a

### Viewing

Please contact our Berkley Kibworth Office on 0116 2796161 if you wish to arrange a viewing appointment for this property or require further information.

 3  2  3  C





# Floor Plan

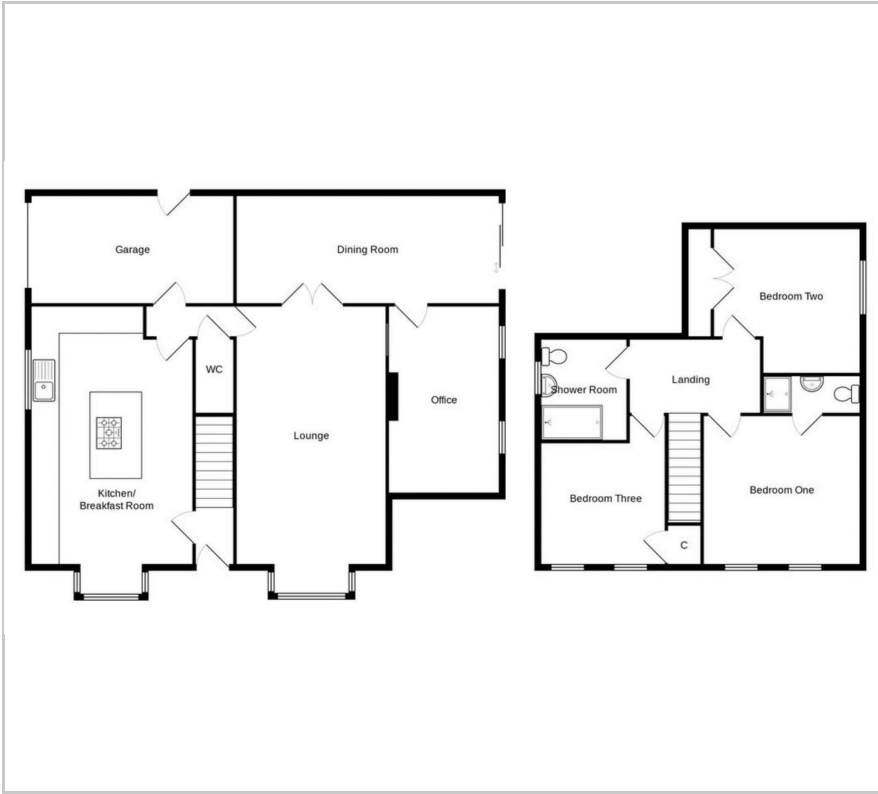

# Area Map



# Energy Efficiency Graph

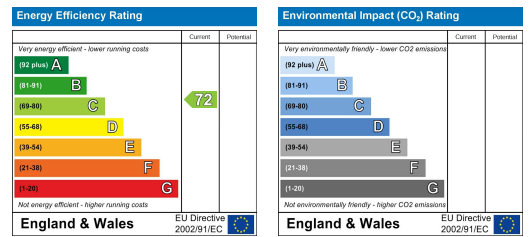

These particulars, whilst believed to be accurate are set out as a general outline only for guidance and do not constitute any part of an offer or contract. Intending purchasers should not rely on them as statements of representation of fact, but must satisfy themselves by inspection or otherwise as to their accuracy. No person in this firm's employment has the authority to make or give any representation or warranty in respect of the property.